

Cage Freewheels SFB

for assembly with inner and outer ring
for exchange of Cage Freewheels BWX



102-1

Application as

- ▶ Backstop
- ▶ Overrunning Clutch
- ▶ Indexing Freewheel

Features

Cage Freewheels SFB are sprag freewheels to be installed between customer-supplied inner and outer rings.

Nominal torques up to 2 070 Nm.

Mounting

The lateral guidance of the Cage Freewheels can be effected either by a shoulder on the outer ring or by guard rings or guard discs which are fixed in the outer ring.

Torque transmission capacity can be increased if several cages are arranged side by side. In this case please consult with RINGSPANN on transmissible torques.

Please note the technical points on page 114 regarding the sprag tracks.

Example for ordering

Freewheel size SFB 44-16 standard type:

- SFB 44-16 J

For exchange of Cage Freewheels BWX

Cage Freewheels BWX	Cage Freewheels SFB
BWX 133590A	SFB 22-10
BWX 13143A	SFB 27-13,5
BWX 133392	SFB 38-16
BWX 1310145	SFB 41-13,5
BWX 132909A	SFB 44-16
BWX 133339	SFB 49-13,5
BWX 1310003	SFB 49-13,5
BWX 137222	SFB 49-19
BWX 1310445	SFB 54-13,5
BWX 1310172	SFB 54-16
BWX 1310226	SFB 54-16
BWX 136709	SFB 54-21
BWX 1310147	SFB 54-25,4
BWX 136324	SFB 57-19
BWX 1310080	SFB 72-13,5
BWX 13168	SFB 72-21
BWX 134012	SFB 72-21
BWX 137322	SFB 79-25,4
BWX 13261A	SFB 103-16

Cage Freewheels SFB

for assembly with inner and outer ring
for exchange of Cage Freewheels BWX

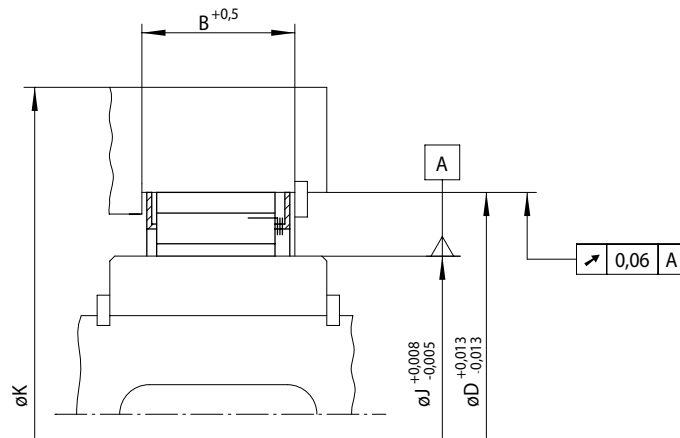

103-1

Indexing Freewheel Overrunning Clutch Backstop	Standard type For universal use	Dimensions

Freewheel Size	Type	Nominal torque M_N Nm	J	D	B	K	Sprags Quantity	Weight kg
			$+0,008$ $-0,005$ mm	$\pm 0,013$ mm	min. mm	mm		
SFB 22-10	J	63	22,225	38,887	10,0	44,0	12	0,03
SFB 27-13,5	J	150	27,767	44,425	13,5	51,0	14	0,05
SFB 38-16	J	360	38,092	54,750	16,0	71,0	18	0,06
SFB 41-13,5	J	340	41,275	57,937	13,5	74,2	14	0,05
SFB 44-16	J	440	44,450	61,112	16,0	78,5	20	0,06
SFB 49-13,5	J	520	49,721	66,383	13,5	85,0	22	0,07
SFB 49-19	J	720	49,721	66,383	19,0	85,0	22	0,10
SFB 54-13,5	J	610	54,765	71,427	13,5	91,7	24	0,07
SFB 54-16	J	610	54,765	71,427	16,0	91,7	24	0,08
SFB 54-21	J	950	54,765	71,427	21,0	91,7	24	0,13
SFB 54-25,4	J	1 180	54,765	71,427	25,4	91,7	24	0,15
SFB 57-19	J	890	57,760	74,427	19,0	95,0	26	0,12
SFB 72-13,5	J	950	72,217	88,882	13,5	115,0	30	0,09
SFB 72-21	J	1450	72,217	88,882	21,0	115,0	30	0,15
SFB 79-25,4	J	2070	79,698	96,363	25,4	124,0	34	0,20
SFB 103-16	J	1600	103,231	119,893	16,0	154,0	40	0,13

The theoretical nominal torque applies only for ideal concentricity between the inner and outer ring.
The maximum transmissible torque is 2 times the specified nominal torque. See page 14 for determination of selection torque.